

section A-A

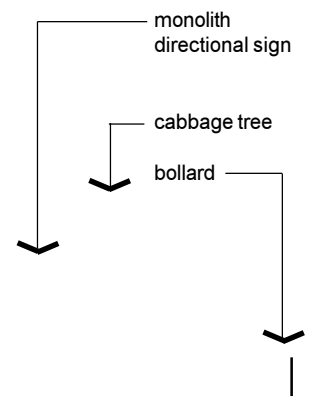

section B-B

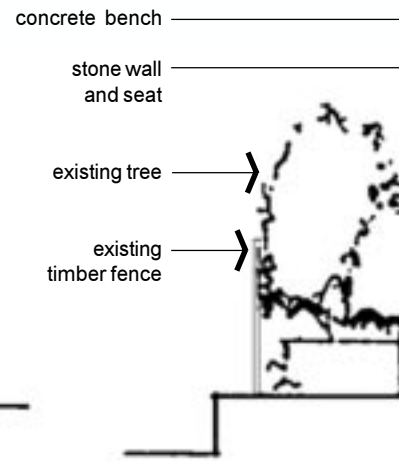
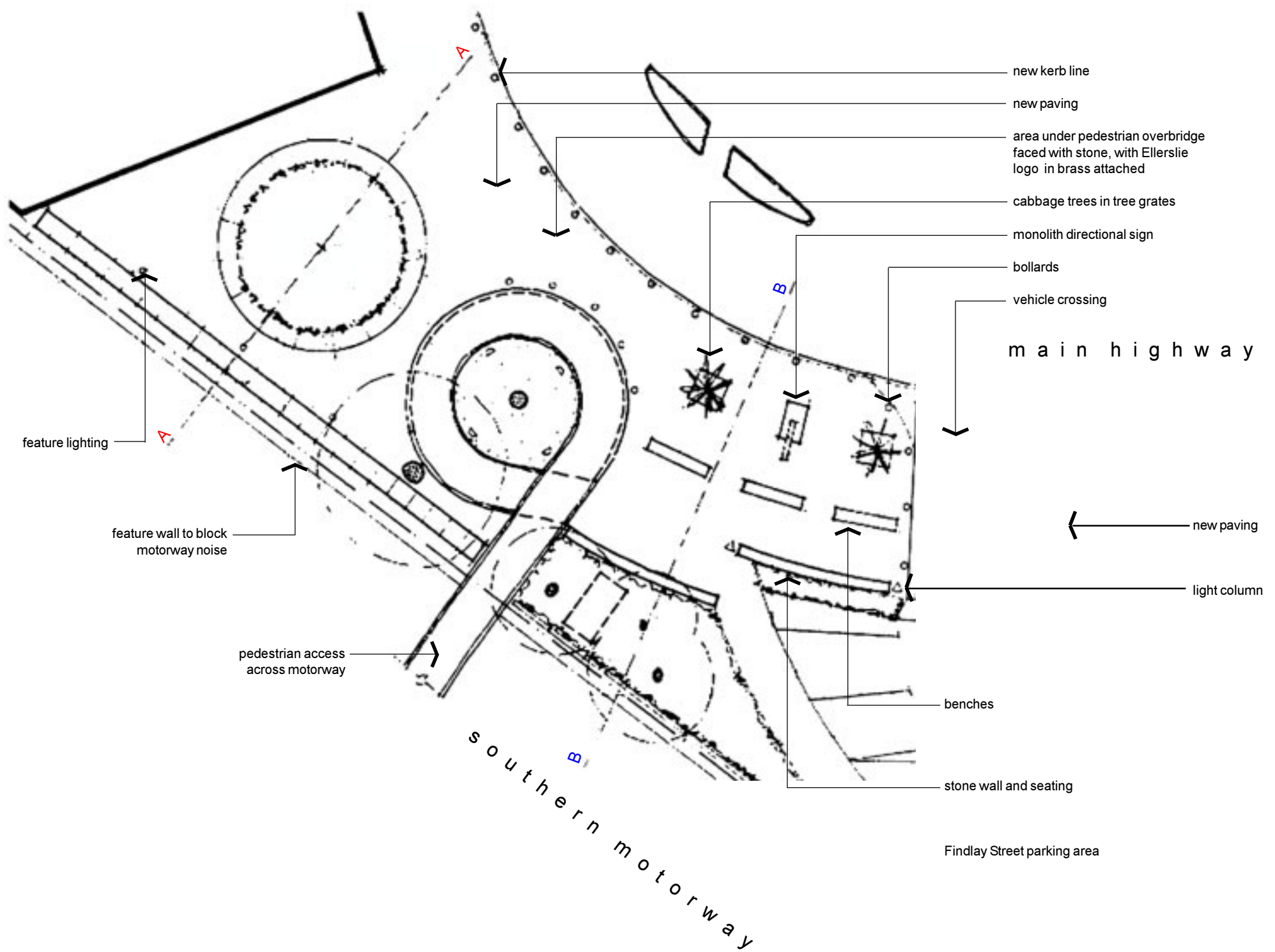

site plan
memory corner

existing norfolk pine

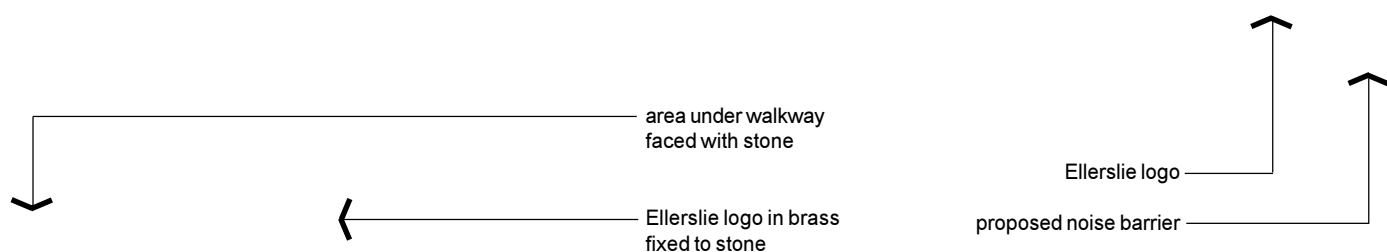

pedestrian walkway

feature wall

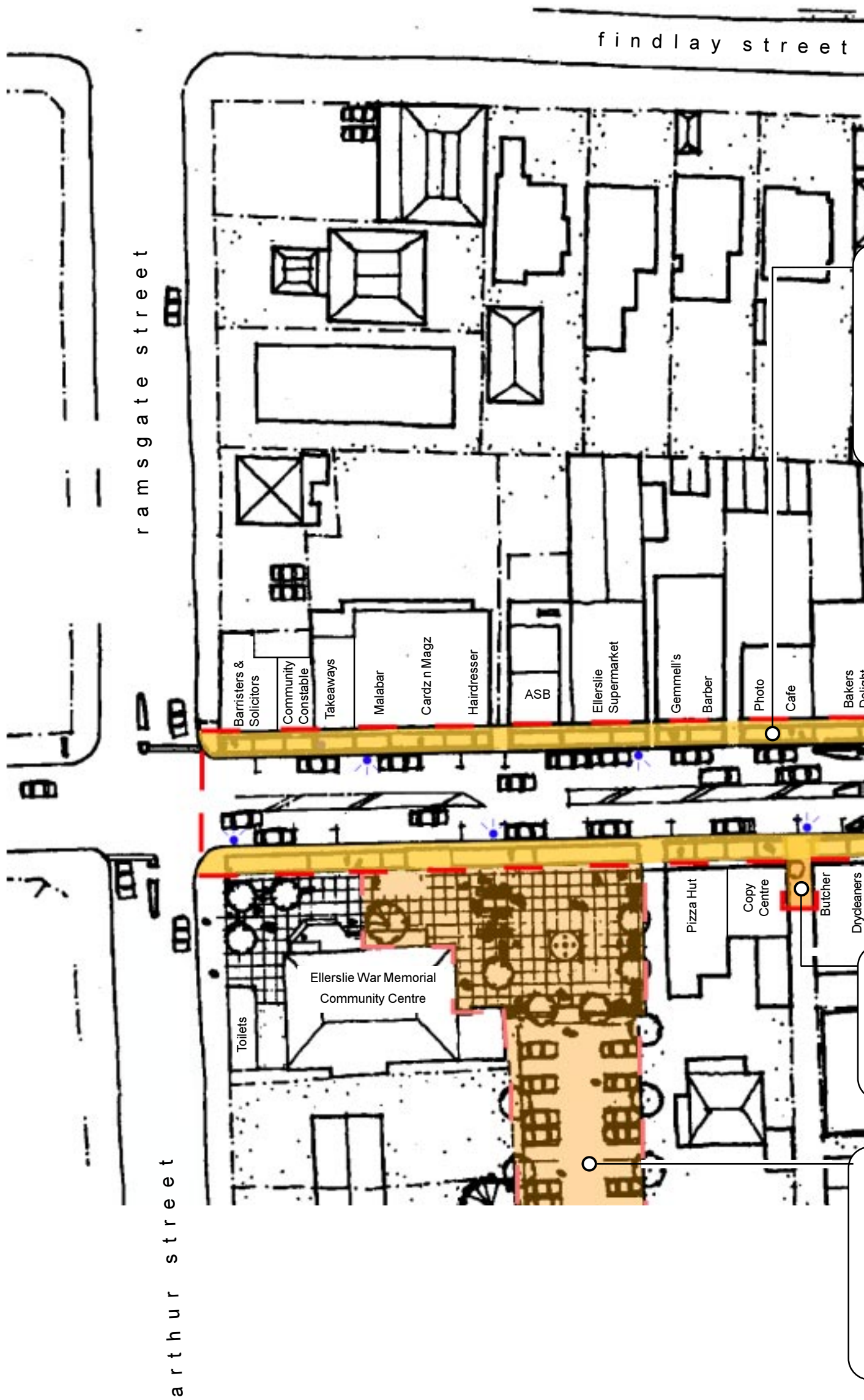

Main Highway

- existing street light columns replaced
- number of street lights increased
- under verandah lighting improved
- street furniture improvements
- reduction of pole clutter

Medical Centre

Pharmacy

Mayfair Wines

Baksho

Richoux

Menswear

Jewellers

Takeaways

Bakery

Takeaways

Four Square

Francoli Resturant & Bar

Pensioner Housing

- entry feature paving treatment
- wall and seating
- gated for security
- planting

Ellerslie Mainstreet Upgrade stage 1
[completed November 2001]

Arthur Street car park
entry walls with planting, lighting, wheel stops installed

Town Square
walls, paving, seating, planting and fountain installed



Ellerslie Mainstreet

stage 2 conc

february 20

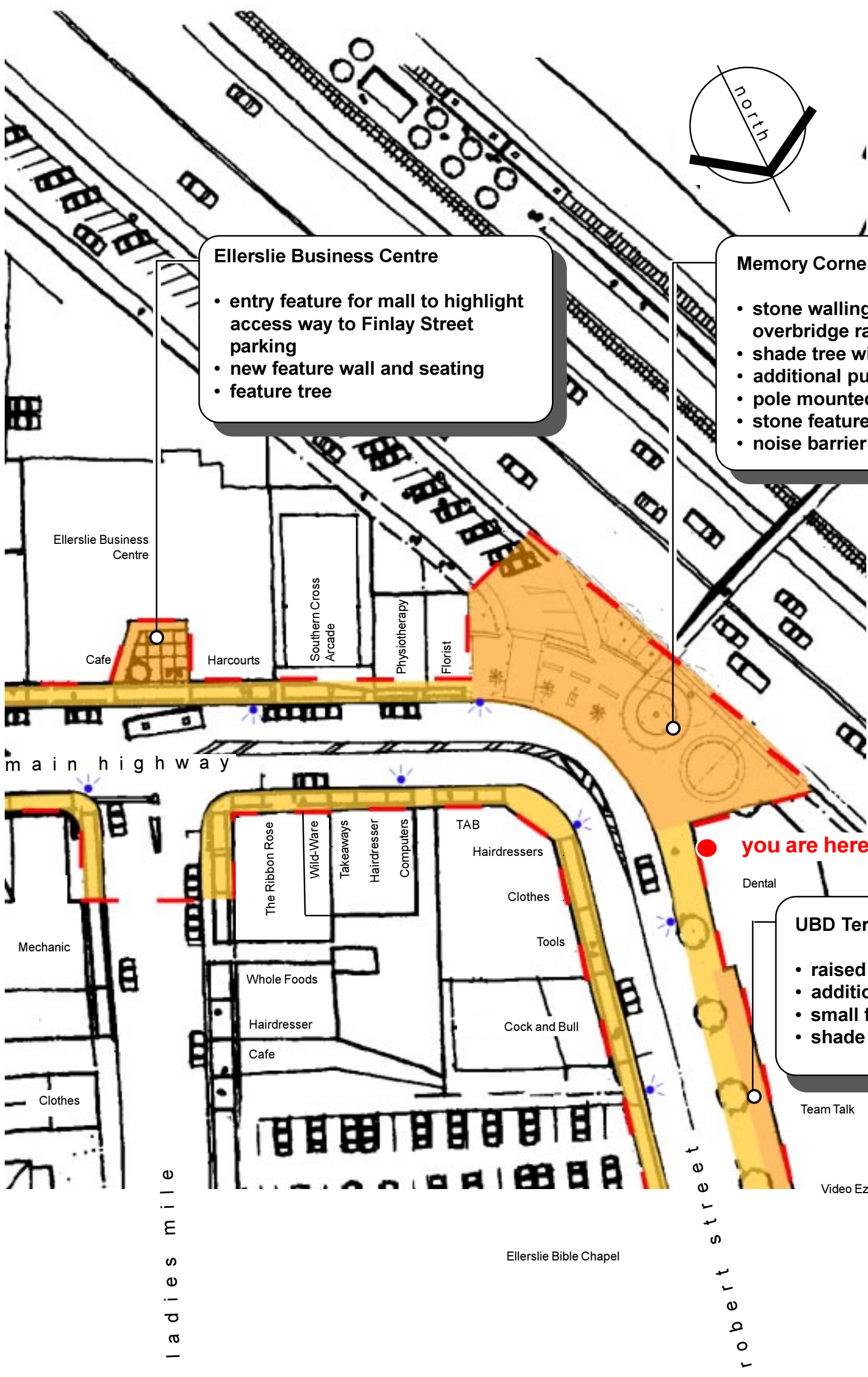

Ellerslie Business Centre

- entry feature for mall to highlight access way to Finlay Street parking
- new feature wall and seating
- feature tree

Memory Corner

- stone walling around base of pedestrian overbridge ramp with feature lighting
- shade tree with feature uplighting
- additional public seating
- pole mounted lighting
- stone feature paving
- noise barrier along motorway edge

UBD Terrace

- raised terrace with feature paving
- additional public seating
- small feature wall
- shade trees

Street Upgrade

Concept plan



p 09 520 5284
f 09 520 5024
e admin@thresher.co.nz
11 Clayton Street, Newmarket
PO Box 109 656 Auckland

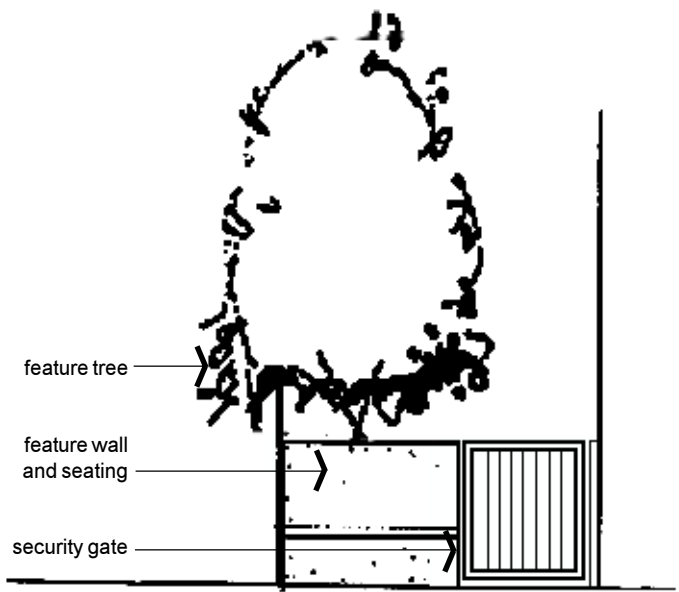

elevation

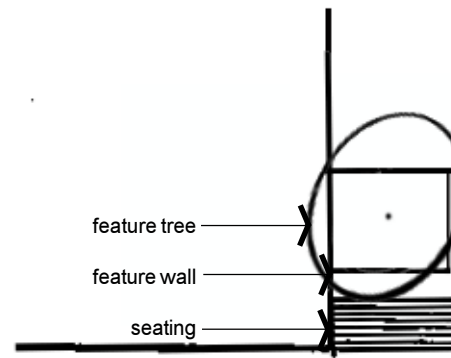

← security gate

entry plan
Pensioner Housing

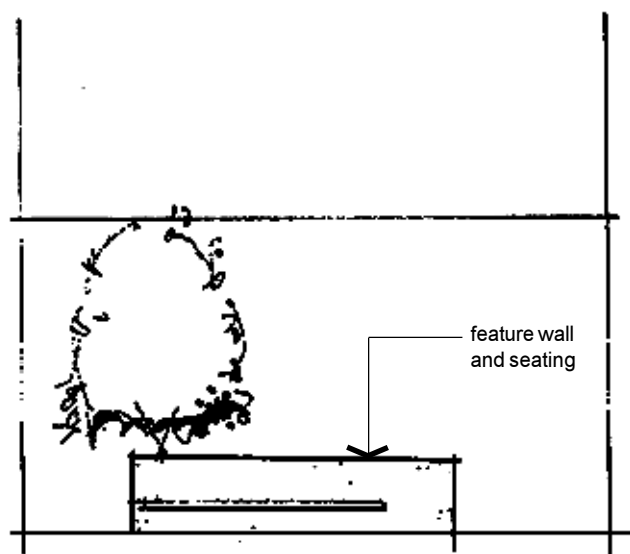

elevation

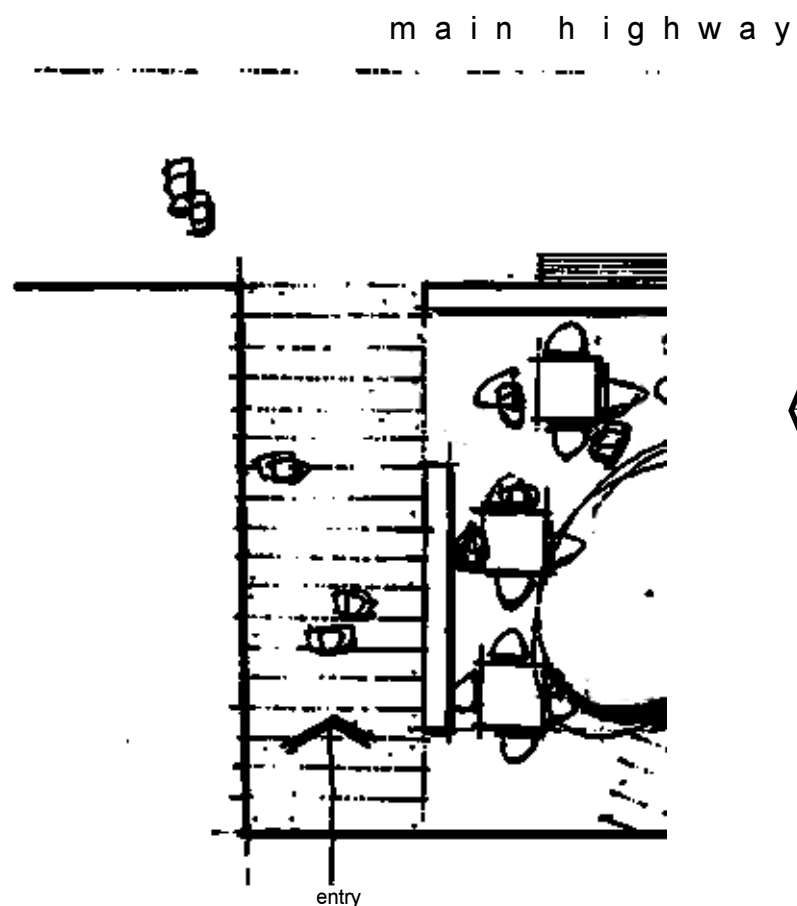

entry plan
Ellerslie Business Centre

Auckland City is developing detailed designs for the streetscape of the Ellerslie Town Centre. This concept plan shows the areas that are to be designed. Your input is essential to the success of the project. Please fill in the submission form provided and post / fax to:

Cameron Rennie - Open Spaces
Project Manager
Community Planning
Auckland City Council
Private Bag 92516
Wellesley Street, Auckland.
Phone: 379 2020
Fax: 307 6003

Robert Street

footpath

terrace

section
UBD Terrace